

CONSTRUCTION UPDATE: NM 68-US 64 Roadway Project Construction Extending South to the Tewa/Albright Intersection Friday, Aug. 20, 2021

NOTE: All construction is weather permitting and subject to change without notice.

Update as of Thursday, August 19, 2021

NOTE: Construction in the center of Paseo del Pueblo Sur will extend south to the Tewa/Albright intersection for approximately 1-2 weeks beginning Friday, Aug. 20.

Construction continues in Phase 2-A

Ojitos to Siler/Los Pandos Intersection

Crews are working in the outside shoulders of Paseo del Pueblo Sur. Traffic is shifted to the center lanes with one lane of traffic open in each direction (north and south).

Siler/Los Pandos to Tewa/Albright Intersections

Crews are working in the center of Paseo del Pueblo Sur. Traffic has been moved to the outside shoulders with one lane of traffic open in each direction (north and south), **see map to right.**

Because barricades are in the center section of the road in this area, to protect construction workers there are NO left turns for motorists heading north or south at the Tewa St/Albright St intersection and all the way north to the Siler Rd/Los Pandos Rd intersection.

Also continuing:

The northern driveways for Ace Hardware, Big 5 Sporting Goods and Smith's Food & Drug are CLOSED, along with the southern driveway for Hinds & Hinds/U-Haul, so crews can extend a concrete box culvert. This work is expected to last through late September or early October. **Access to all of these businesses will be maintained through alternate driveways.**

Regular work hours are **7 a.m. to 6:30 p.m. Monday-Friday**, although crews may work longer hours or on weekends as needed.

Motorists traveling through this area should expect delays and obey the 25-miles-per-hour speed limit.

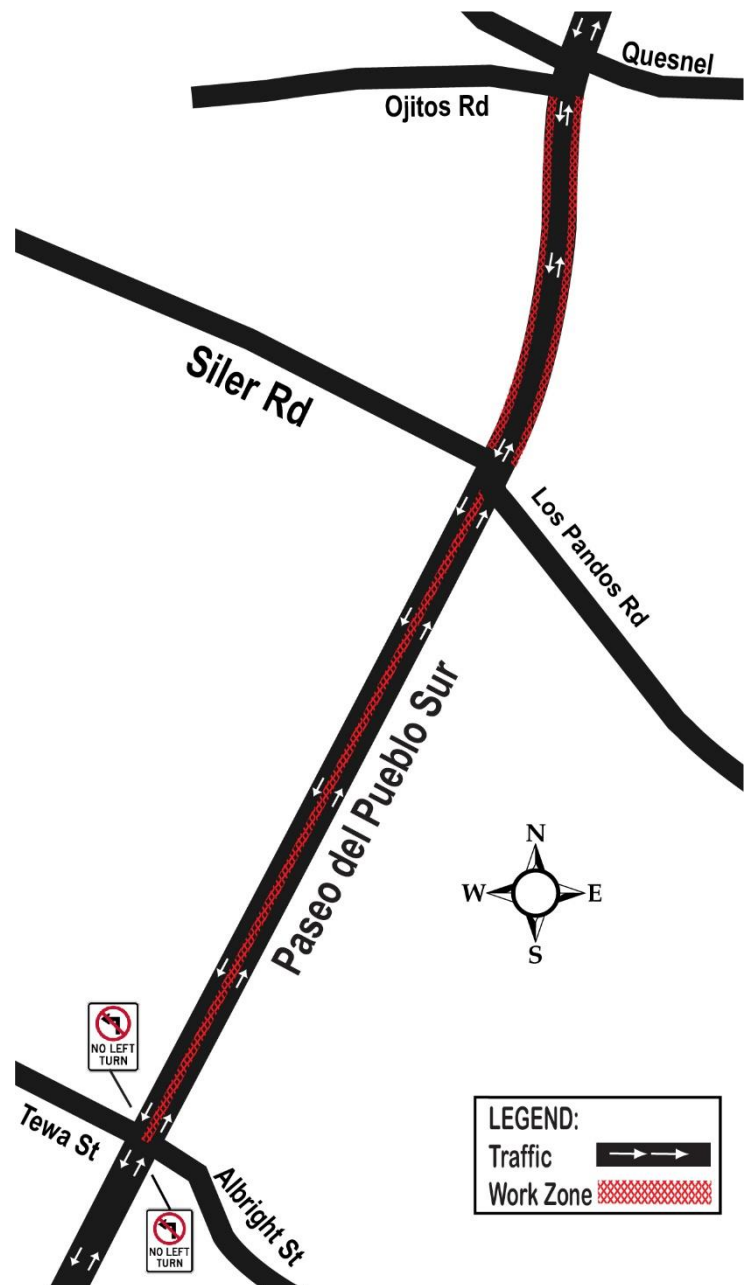

For more information, to ask questions or to sign up for free email updates, visit the project website, **www.taosnm6864.com**, or call Patti Watson at 1-800-687-3417 or 505-269-9691. Info is also available at **www.nmroads.com**.